

## SPECIFICATIONS

CHARACTERISTICS	1	Manufacturer			Tailift Z1000		Tailift Z1000		Tailift Z1000		Tailift Z1000		Tailift Z1000	
					ZFD18		ZFG18		ZFD20		ZFG20		ZFD25	
					ZFD30		ZFG30		ZFD35		ZFG35			
2	Series													
3	Model													
4	Capacity	Q	Load	kg	1800		2000		2500		3000		3500	
5	Load center	C	Distance	mm	500		500		500		500		500	
6	Power type		Electric, Diesel, Gasoline, LPG		Diesel		Gasoline		Diesel		Gasoline		Diesel	
7	Operation type		Pedestrian, Stand, Sit	mm	Sit		Sit		Sit		Sit		Sit	
8	Tire type		S=Solid, P=Pneumatic	front/rear	P/P		P/P		P/P		P/P		P/P	
9	Wheels (X-driven)		Number	front/rear	2X/ 2		2X/2		2X/2		2X/2		2X/2	
10		h3	Lift	mm	3000		3000		3000		3000		3000	
11	Lift at 2-stage mast	h2	Standard free lift	mm	0		0		0		0		0	
12		h5	Optional free lift	mm	1490		1490		1490		1490		1490	
13	Load bracket	h8	Height of load bracket	mm	1220		1220		1220		1220		1220	
14	Fork size		Thickness(s) × Width(e) × Length(l)	mm	35x100x1070		40x122x1070		40x122x1070		45x122x1070		50x122x1070	
15	Mast tilting angle		Forward (α) / Back (β)	deg	6° / 12°		6° / 12°		6° / 12°		6° / 12°		6° / 12°	
16		L2	Length to face of forks	mm	2390		2645		2645		2760		2910	
17		B	Total width	mm	1065		1160		1160		1270		1270	
18	overall dimensions	h1	Mast height lowered	mm	1990		1990		1990		2000		2000	
19		h4	Mast height extended (w/o bracket)	mm	3720		3720		3720		3720		3720	
20		h4	Mast height extended	mm	4220		4220		4220		4220		4220	
21		h6	Overhead guard height	mm	2140		2180		2180		2210		2210	
22		h7	Seat height	mm	1150		1120		1120		1180		1180	
23	Turning radius	R		mm	2060		2170		2200		2365		2600	
24	Load distance	X	From center of front axle	mm	440		500		500		510		510	
25			number	front/rear	2/2		2/2		2/2		2/2		2/2	
26	Tire size		front	mm	6.50-10-10PR		7.00-12-12PR		7.00-12-12PR		8.15-15-12PR		8.15-15-14PR	
27			rear	mm	5.00-8-8PR		6.00-9-10PR		6.00-9-10PR		6.50-10-10PR		6.50-10-10PR	
28	Wheelbase	Y		mm	1480		1650		1650		1700		1850	
29	Tread		Center of tires front	mm	890		1050		1050		1050		1050	
30			Center of tires rear	mm	900		975		975		975		975	
31	Ground clearance	m1	at lowest point	mm	110		110		110		120		120	
32		m2	center of wheelbase	mm	155		170		170		210		210	
33	Service brake		operation/control		Hydraulic		Hydraulic		Hydraulic		Hydraulic		Hydraulic	
34	Parking brake		operation/control		Foot		Foot		Foot		Foot		Foot	

## Engine

Model	ZFD18-25		ZFD20-35		ZFG18-25		ZFG20-35
Manufacturer	Isuzu	Yanmar	Isuzu	Yanmar	Yanmar	Nissan	Nissan
Engine Model	C240PKF-23	4TNE-94	4JG2	4TNE-94	4TNE-98	K21	K25
Speed	rpm	2500	2200	2450	2200	2450	2300
Output	kw	34.6	34.2	44.8	34.2	44.1	31.2
cylinders no./displacement	--/cc	4/2369	4/3054	4/3059	4/3054	4/3319	4/2488

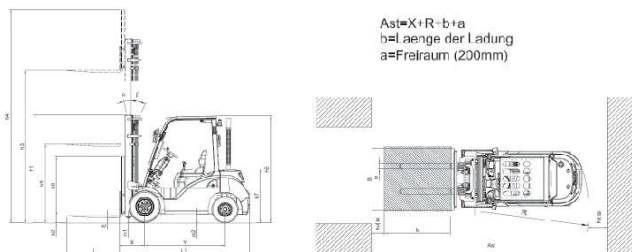

## TAI WAN MAIN OFFICE

No. 5, ZiLi 1st Rd., Nankang Industrial Zone, Nantou City,  
Nantou County 54067, Taiwan (R. O. C.)  
TEL: +886 49 2263800 FAX: +886 49 2252919  
http://www.tailift.com  
Mail: insales@tailift.com.tw

## TAICHUNG OFFICE

269, Sec 1, Shein Lin Rd, Taya, Taichung, Taiwan, R. O. C.  
TEL: 04-25658816 FAX: 04-25658817

DOC. S/N: DEB040

Edition: 04



FD/FG 1.8-3.5 ton  
IC FORKLIFT TRUCKS



Tailift offer you extra value and high quality lift truck.

Tailift lift truck is the best solution to your materials handling needs.

Tailift all new Z series is complete new design with innovation

Tailift offer you extra value and high quality lift truck.

Tailift lift truck is the best solution to your materials handling needs.

Tailift all new Z series is complete new design with innovation.

Tailift will show you how the Z series sets new standard in 5 main areas : **great performance, comfort& ergonomic , easy operation and safety** for operator and real value for our customer through an impressively **low cost of ownership**, also committed to providing unparalleled **after sales service**.

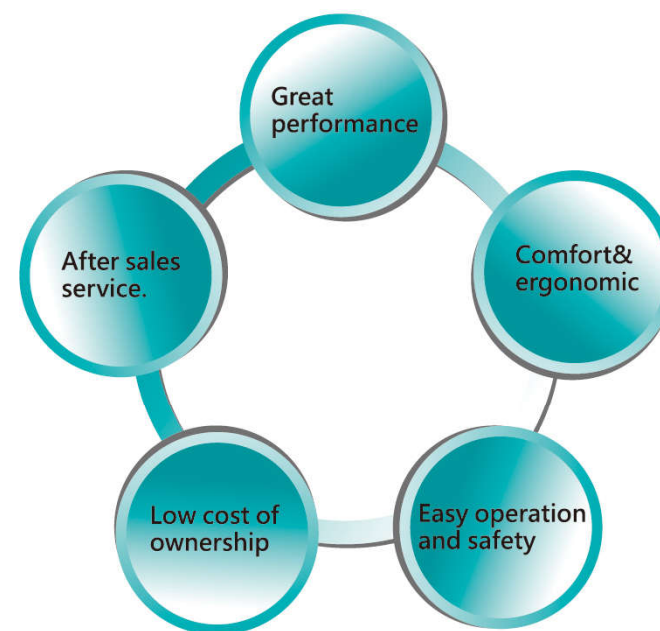



## True Productivity with Great Performance

**Tailift** | Z series

Tailift Z series forklift trucks are designed to boost performance and to increase productivity and manufactured to be the most dependable truck in today's market.



### Low noise Low vibration

#### Standard with suspension transmission

The remarkable Suspended power train with a flexi-coupling to the drive axle is a big innovation which achieve low noise and vibration. The noise has been reducing to **79db**. The Z series enclosure body also prevents operation noise from escaping into the opening area.

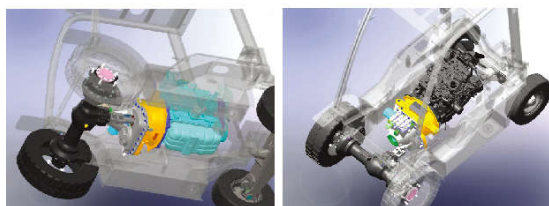

### High Performance and low fuel consumption engines

You can choose your engine to suit your particular application and conditions include Isuzu, Yanmar, Nissan engine. All engines meet EU and EPA emission. These industry-leading engines have been applied to provide great performance, low fuel consumption, low noise, easy maintenance and low service cost.

	1800kg-2000kg	2500-3500kg
Diesel Engine	Isuzu C240 Yanmar 4TNE92	Isuzu 4JG2 Yanmar 4TNE98
Gasoline Engine	Nissan K21	Nissan K25



### How the Z series raises your productivity

#### Steering

Superior turning radius and smart. The new axle provides wider steering angles to **85 degree** and reduce to a smaller turning radius. Its compact size allows the truck to work in narrower aisles.

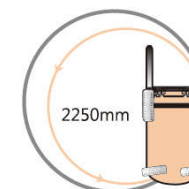

#### Lifting

The faster lifting speed will reduce your working hours and lower your operation costs



#### Acceleration

15% Higher Accelerating Ability. Reducing the driving time on same travel distance, increasing productivity

#### Braking

Using industrial oil-immersed disc brakes design, which has 3 times brake shoe durability and friction areas. longer running hours (4000~8000hours) without brake adjustment and reduce your maintenance cost.

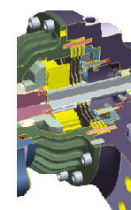
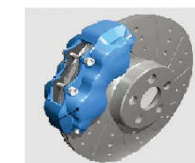

#### Multi-disc clutch

The multi-disc clutch design ensures high torque capacity permitting smooth direction change. The Z series transmission have 4 pieces plates and bigger clutch pack improve frictional force and reduce wear out speed.

Relief valve design to decrease oil pressure impulse.  
The forward and reverse solenoid valve are integral, allow quick direction change.  
Enlarge oil filter given better oil cleanliness.

## Surprisingly comfortable & Ergonomics (STD)

The Z series innovative ergonomic features were designed to help make operator more comfortable and, as result, more productive.

### Smaller steering wheel

easy to operate and reduce operator's arm and shoulder's workload. Diameter reduce from 350mm to 300mm. The easy-handling steering wheel column with tilt adjustment helps to provide the ideal operating position and improve performance.

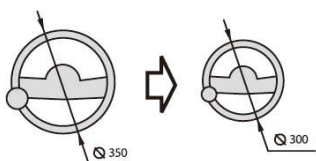

### Adjustable steering wheel column

The easy-handling steering wheel column with tilt adjustment helps to provide the ideal operating position and improve performance.

### Long operator assist grips

designed to meet the needs of varying operator sizes



### Pedal type parking brake

Operator can use one foot to control parking brake without changing body position



### Multifunctional LCD instrument panel

A large and easy-to-read multifunctional LCD panel is ergonomic designed for the operator. Which is design 40 degree on the right hand angle of the operator and help operator to read.

### Internal hidden tilt cylinder

Internal hidden tilt cylinder avoids and reduces scrape possibility. Enlarge access space and given better appearance.

### Hydraulic control

The ergonomic design of levers are provide the perfect positions for operator's hand without causing any extra stress.



### Clear view and Enlarge operation space

excellent visibility and higher residual load capacity

- Standard 150mm free lift
- Low profile front cowl
- Back type roller
- Hiding hose design
- New fork carriage



Upward visibility



Forward visibility



Fork tip visibility

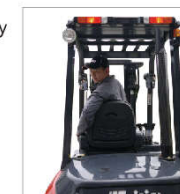

Rear visibility



### Enlarged space give great comfortable and Increasing productivity.

380mm wide -open foot space provides the comfortable foot activity space. It is about 30% wider than 7 series.





## Surprisingly comfortable & Ergonomic (optional)

### Superior comfort cabin

New Z series is focusing on working environment and operator's comfort. The new cabin designed with no blind spot. It is a comfortable and safe work place for the operator. The Cabin's 360 degrees crystal view minimums the risk of damage to operator and goods. Wide range of optional equipments such as heater and radio in the interior lining of the overhead guard to meet all your needs. Quality components, an Insulated engine compartment, as well as the construction itself, ensure a low noise and vibration level.

### Rubber suspended cabin:

- Operator comfort
- Vibration-free
- Functional arrangement
- Low noise level
- Ergonomic operation

Optional advanced hydraulics Minlever and joystick with armrest are all new design give more comfort to the operator.



Mini Levers



Radio



Radio

### Integral sideshifter (option)

minimums truck movements for shipping and receiving loads and increase overall operator efficiency.





## Easy operation and safety

easy-operating controls and a arrange of available options to give operators better, more efficient control and provide higher productivity.

### Electric F/R control lever

- One-piece lever offers easy shifting between forward and reverse while keeping both hands on the wheel. It is easy to reach and fast to change direction.
- Enlarge light switch  
Integrated with turn signal levers into the slim profile steer column for easy accessibility and simple operation.
- Low profile front cowl with sloped dashboard provide an unobstructed view in any position.



### Integral heavy duty chassis

A strong no-bolt integral heavy duty chassis gives the driver 20% more protection from falling loads.



### Hydraulic lock out system

Our new hydraulic lock out system option which automatically lock off all hydraulic functions and transmission drive if it has not detected the presence of the operator.



### Low truck centre of gravity for best stability

Allow high residual capacities even at high lifts.

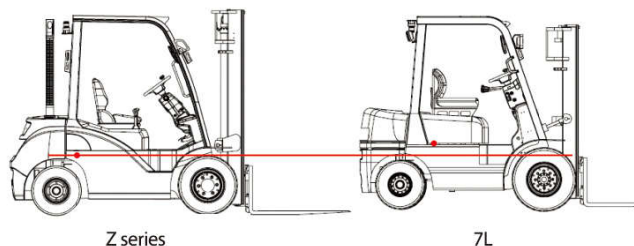

Hydraulic safety valve to absorb mast dropping speed, avoid the accident happen.

## Low cost of ownership + World Class Dependability

### + Superior Serviceability

simplify mechanical linkage to reduce drive component wear and tear. Extend brake pedal and mechanical working life.

The new Hydraulic steering axle using high and low blockage fixed way to fix shaft, Grease nipples located on the contact points extend working life time and lower maintenance cost.

## Easy maintenance + Good technical support

### Fast & simplified Serviceability

- The new hood open angle has been enlarged to 70 degree.
- Removable side-plate on side of truck enlarge maintenance space
- Radiator top Cover No tool needed to open
- using steel piping, clean and tidy fitting , durable and easy to maintain

### Experience Technical support

We offer extensive customer support and service for our entire range of material handling products – both past and present. Our experienced technicians are always on hand to help with product installation, maintenance and questions relating to Tailift material handling products.

### Spare parts-Fast delivery, Flexible service, competitive pricing

Our spare part inventory warehouse containing nearly 40,000 items with over 150,000 product applications. If ordered before 15:00 h. Eastern Time , required spare parts can be delivered to you or to our service engineer the next day. Tailift utilizes our years of experience, fast delivery, flexible service and competitive pricing to make the maintenance of your forklift as cost-effective and painless as possible.

